

ELSIE EP61 SERIES



PRESSURE GAGE

Features

- Pressure unit on display
- User programmable pressure unit :
psi \ bar \ kgf/cm² \ kPa and MPa
- Accurate read out with wide viewing angle
- Dust and splash-proof IP65 enclosure
- LCD Display



■ SPECIFICATION

TYPE		EP61V (Vacuum)	EP61P (Positive)
1 MPa			
0			
-101kPa			
Rated pressure range		0 ~ -101 kPa	0.000 ~ 1.000 MPa
Display pressure range		10 ~ -101 kPa	-0.100 ~ 1.000 MPa
Withstand pressure		300 kPa	1.5 MPa
Applicable fluid		Filtered air, incombustible and non-corrosive gases	
Pressure resolution	kPa	1	--
	MPa	--	0.001
	kgf/cm ²	0.01	0.01
	bar	0.01	0.01
	psi	0.1	0.1
Power supply voltage		12 to 28V DC ±10%, Ripple (P-P) 10% or less	
Current consumption		10mA	
Sampling rate		2 Hz (2 times/sec.)	
Pressure unit		psi, bar, kgf/cm ² , kPa user selectable	psi, bar, kgf/cm ² , MPa user selectable
Repeatability		≤ ±0.2% F.S. ±1digit	
LCD display		3 ½ digit LCD display, 7 segment	
Indicator accuracy		≤ ±2% F.S. ±1 digit (ambient temperature: 25 ±3 °C)	
Environment	Enclosure	IP 65(*)	
	Ambient temp. range	Operation: 0 ~ 50 °C, storage: -10 ~ 60 °C (No condensation or freezing)	
	Ambient humidity range	Operation/Storage: 35 ~ 85% RH (No condensation)	
	Withstand voltage	1000V AC in 1-min (between case and lead wire)	
	Insulation resistance	50Mohm min. (at 500V DC, between case and lead wire)	
	Vibration	Total amplitude 1.5mm or 10G, 10Hz-55Hz-10Hz scan for 1 minute, two hours each direction of X, Y and Z	
Shock		100m/s ² (10G), 3 times each in direction of X, Y and Z	
Temperature characteristic		≤ ±2% F.S. of detected pressure (25 °C) at temp. range of 0~50 °C	
Port size		F1:1/8"PT, M5; F2:1/8"NPT, 10-32 UNF; F3:G1/8", M5	
Lead wire		Oil-resistance cable (0.15mm ²)	
Weight		Approx. 60g (with 2-meter lead wire)	

*Air tube must be installed to maintain IP65.

■ PANEL DESCRIPTION

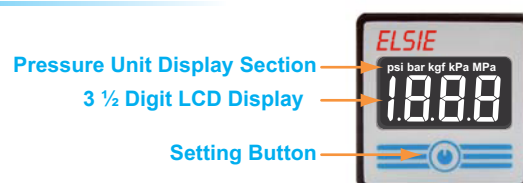

ORDERING INFORMATION

E P 6 1 P - F 1

Pressure Range

V : Vacuum (10 ~ -101kPa)
P : Positive (-0.100 ~ 1.000MPa)

Pressure Port

F1 : 1/8" PT, M5
F2 : 1/8" NPT, 10-32 UNF
F3 : G1/8" , M5

Optional Parts

BT-5 : Mounting bracket
BT-6 : Mounting bracket
PA-C : Panel adapter
PA-D : Panel adapter + Front protective lid

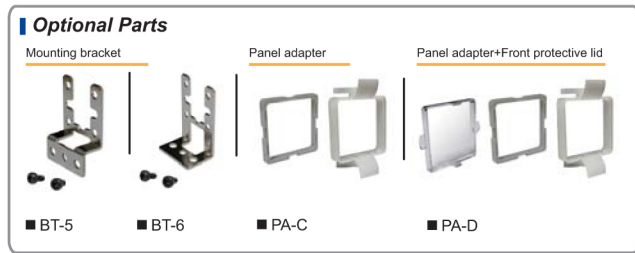

DIMENSIONS

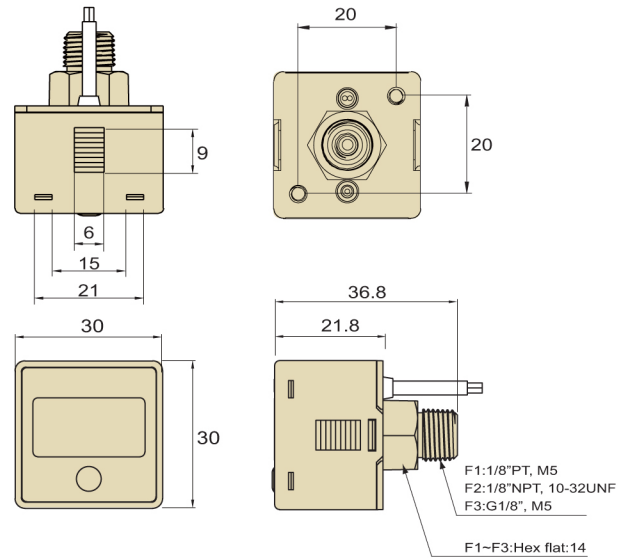

Unit:mm

OPTIONAL PARTS DIMENSIONS

1 Mounting Bracket

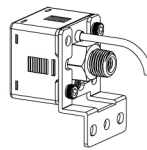
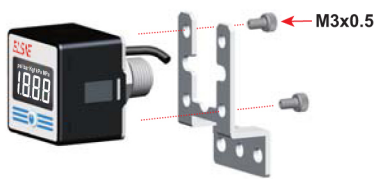

Mounting bracket BT-5

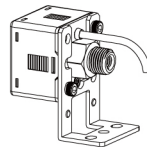
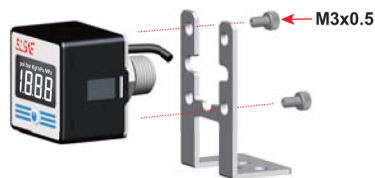
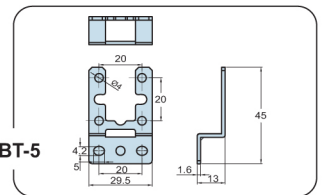

Mounting bracket BT-6

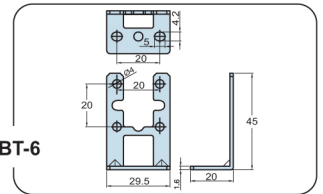

2 Panel Mount Adapter + Front Protective Lid

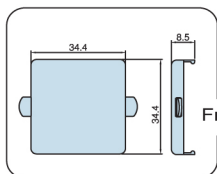

Front protective lid

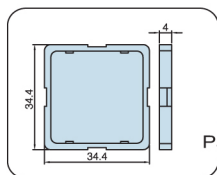

Panel adapter

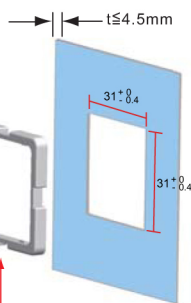

Panel adapter

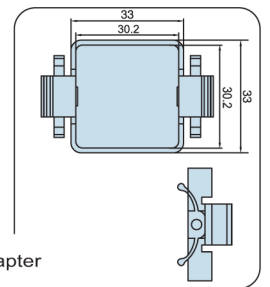

Unit:mm